



COUNTY OF HENRICO, VIRGINIA

MONUMENT DESCRIPTION



NAME OF STATION:

54

SET MAY 1998

VERTICAL CONTROL

NAVD 88 (Feet): ELEV. = 149.8
 NAVD 88 (Meters): ELEV. = 45.66

HORIZONTAL CONTROL

Horizontal Control Based On NAD 83 (93):

VA STATE PLANE COORDINATES (SOUTH ZONE):

NORTHING (FEET): 3713614.366 NORTHING (METERS): 1131911.923
 EASTING (FEET): 11834852.445 EASTING (METERS): 3607270.240

GEOGRAPHIC COORDINATE SYSTEM:

LATITUDE (Y): 37 30 56.80679
 LONGITUDE (X): 77 17 11.52211

MONUMENT DESCRIPTION :

Station is a 2" Bronze Disk set in place in a 6" concrete monument

To reach the station from the intersection of Route 295 and Route 60 (Williamsburg Road), proceed west 0.8 mile along Williamsburg Road to the station on the right in the grass. Station is set flush with the ground.

Azimuth Mark Monument #54A

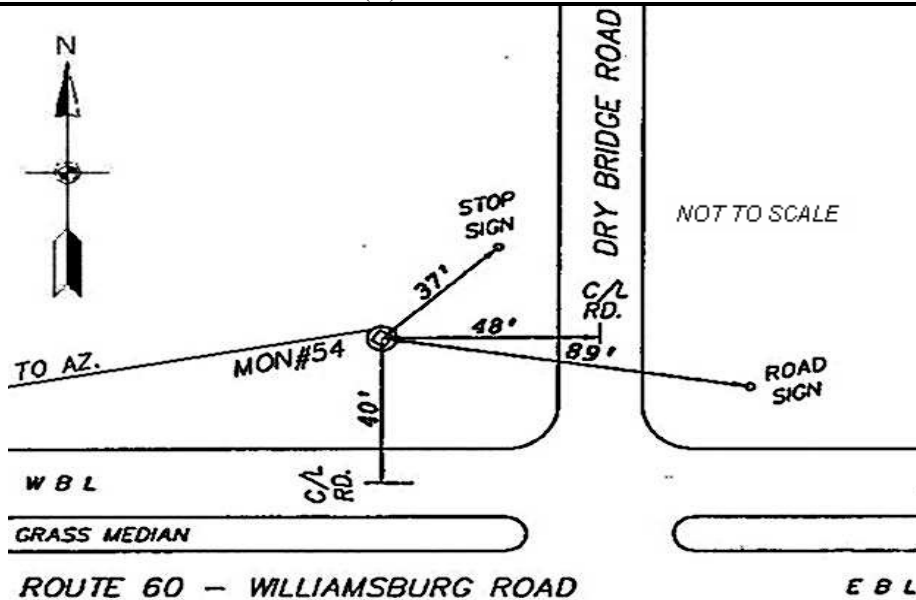
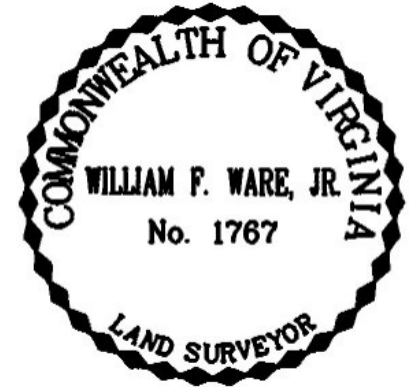



COUNTY OF HENRICO, VIRGINIA

MONUMENT DESCRIPTION



NAME OF STATION: **54 A** SET JUNE 2000

VERTICAL CONTROL

NAVD 88 (Feet): ELEV. = 155.9
NAVD 88 (Meters): ELEV. = 47.52

HORIZONTAL CONTROL

Horizontal Control Based On NAD 83 (93):

VA STATE PLANE COORDINATES (SOUTH ZONE):

NORTHING (FEET): **3714357.209** NORTHING (METERS): **1132138.342**
EASTING (FEET): **11833546.273** EASTING (METERS): **3606872.118**

GEOGRAPHIC COORDINATE SYSTEM:

LATITUDE (Y): 37 31 4.31640
LONGITUDE (X): 77 17 27.61540

MONUMENT DESCRIPTION :

Station is a 2" Bronze Disk set in place in a 6" concrete monument

To reach the station from the intersection of Route 295 and Route 60 (Williamsburg Road), proceed west 1.1 miles along Williamsburg Road to the station on the right in the grass. Station is set flush with the ground.

