



COUNTY OF HENRICO, VIRGINIA

MONUMENT DESCRIPTION



NAME OF STATION: **75** **SET MAY 1998**

VERTICAL CONTROL

NAVD 88 (Feet): ELEV. = 161.7
NAVD 88 (Meters): ELEV. = 49.29

HORIZONTAL CONTROL

Horizontal Control Based On NAD 83 (93):

VA STATE PLANE COORDINATES (SOUTH ZONE):

NORTHING (FEET): **3715504.776** NORTHING (METERS): **1132488.121**
EASTING (FEET): **11822612.149** EASTING (METERS): **3603539.390**

GEOGRAPHIC COORDINATE SYSTEM:

LATITUDE (Y): 37 31 17.02445
LONGITUDE (X): 77 19 43.15039

MONUMENT DESCRIPTION :

Station is a 2" Bronze Disk set in place in a 6" concrete monument.

To reach the station from the intersection of Route 64 and Airport Drive, proceed south 0.6 mile along Airport Drive to the station on the right in the grass. Station is set flush with the ground.

Azimuth Mark Monument #75A

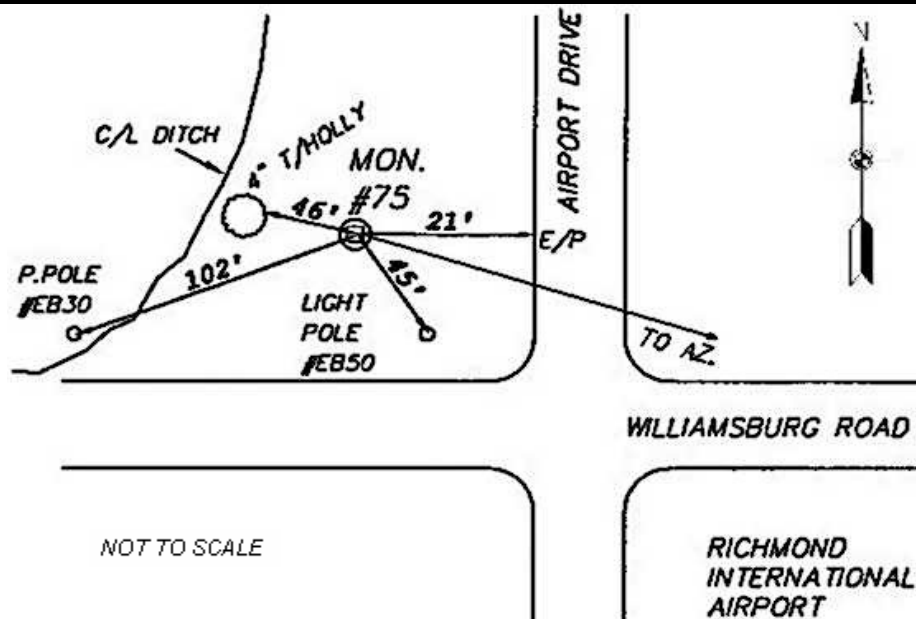



COUNTY OF HENRICO, VIRGINIA

MONUMENT DESCRIPTION



NAME OF STATION: **75A** SET JUNE 2000

VERTICAL CONTROL

NAVD 88 (Feet): ELEV. = 161.8
NAVD 88 (Meters): ELEV. = 49.32

HORIZONTAL CONTROL

Horizontal Control Based On NAD 83 (93):

VA STATE PLANE COORDINATES (SOUTH ZONE):

NORTHING (FEET): 3715698.425 NORTHING (METERS): 1132547.145
EASTING (FEET): 11823338.557 EASTING (METERS): 3603760.800

GEOGRAPHIC COORDINATE SYSTEM:

LATITUDE (Y): 37 31 18.84971
LONGITUDE (X): 77 19 34.10408

MONUMENT DESCRIPTION :

Station is a 2" Bronze Disk set in place in a 6" concrete monument.

To reach the station from the intersection of Airport Drive and Williamsburg Road, proceed east 0.14 mile along Williamsburg Road to the station on the right in the grass. Station is set flush with the ground.

