



COUNTY OF HENRICO, VIRGINIA

MONUMENT DESCRIPTION



NAME OF STATION:

87

SET MAY 1998

VERTICAL CONTROL

NAVD 88 (Feet): ELEV. = 188.3
NAVD 88 (Meters): ELEV. = 57.39

HORIZONTAL CONTROL

Horizontal Control Based On NAD 83 (93):

VA STATE PLANE COORDINATES (SOUTH ZONE):

NORTHING (FEET): 3744542.707 NORTHING (METERS): 1141338.900
EASTING (FEET): 11794668.909 EASTING (METERS): 3595022.274

GEOGRAPHIC COORDINATE SYSTEM:

LATITUDE (Y): 37 36 7.38955
LONGITUDE (X): 77 25 25.88679

MONUMENT DESCRIPTION :

Station is a 2" Bronze Disk set in place in a 6" concrete monument.

From the intersection of Azalea Avenue and Richmond/Henrico Turnpike, proceed 186 feet south on Richmond Henrico Turnpike to the station on the left in the grass, north of the gas station entrance. Station is set 0.1 foot below the ground.

Azimuth Mark Monument #87A

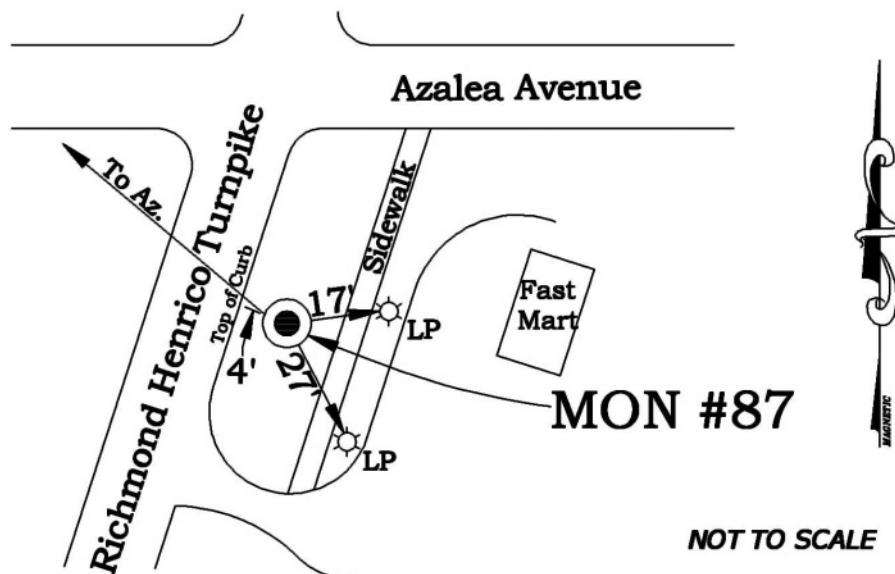



COUNTY OF HENRICO, VIRGINIA

MONUMENT DESCRIPTION



NAME OF STATION:

87A

SET JUNE 2000

VERTICAL CONTROL

NAVD 88 (Feet): ELEV. = 194.7

NAVD 88 (Meters): ELEV. = 59.34

HORIZONTAL CONTROL

Horizontal Control Based On NAD 83 (93):

VA STATE PLANE COORDINATES (SOUTH ZONE):

NORTHING (FEET): 3745174.551 NORTHING (METERS): 1141531.486

EASTING (FEET): 11794431.565 EASTING (METERS): 3594949.931

GEOGRAPHIC COORDINATE SYSTEM:

LATITUDE (Y): 37 36 13.66284

LONGITUDE (X): 77 25 28.74653

MONUMENT DESCRIPTION :

Station is a 2" Bronze Disk set in place in a 6" concrete monument.

To reach the station from the intersection of Richmond/Henrico Turnpike and Azalea Avenue, proceed west 0.09 mile along Azalea Avenue to Wilkinson Road, turn right on Wilkinson Road, then go 0.05 mile to the station on the right in the grass. Station is set flush with the ground.

