



Henrico County
2008

Recorded Single Family Subdivisions



County of Henrico Planning Department
January 2009

The *Recorded Single-Family Subdivision Report*, compiled annually by the Henrico County Planning Department, records single family subdivisions by Magisterial District. The units and acreage recorded in the report account for all units and acreage approved for each section of the subdivisions as recorded with the record of deeds in the Circuit Court Clerk's Office.

The data used to create the reports is derived from Henrico County's Planning Department records of recorded subdivisions. This information is documented by the Henrico County Planning Department after the final plat is recorded in the Circuit Court Clerk's Office.

For more information contact the Planning Department at (804) 501-4602.

Henrico County

Single Family Lots Recorded in 2008

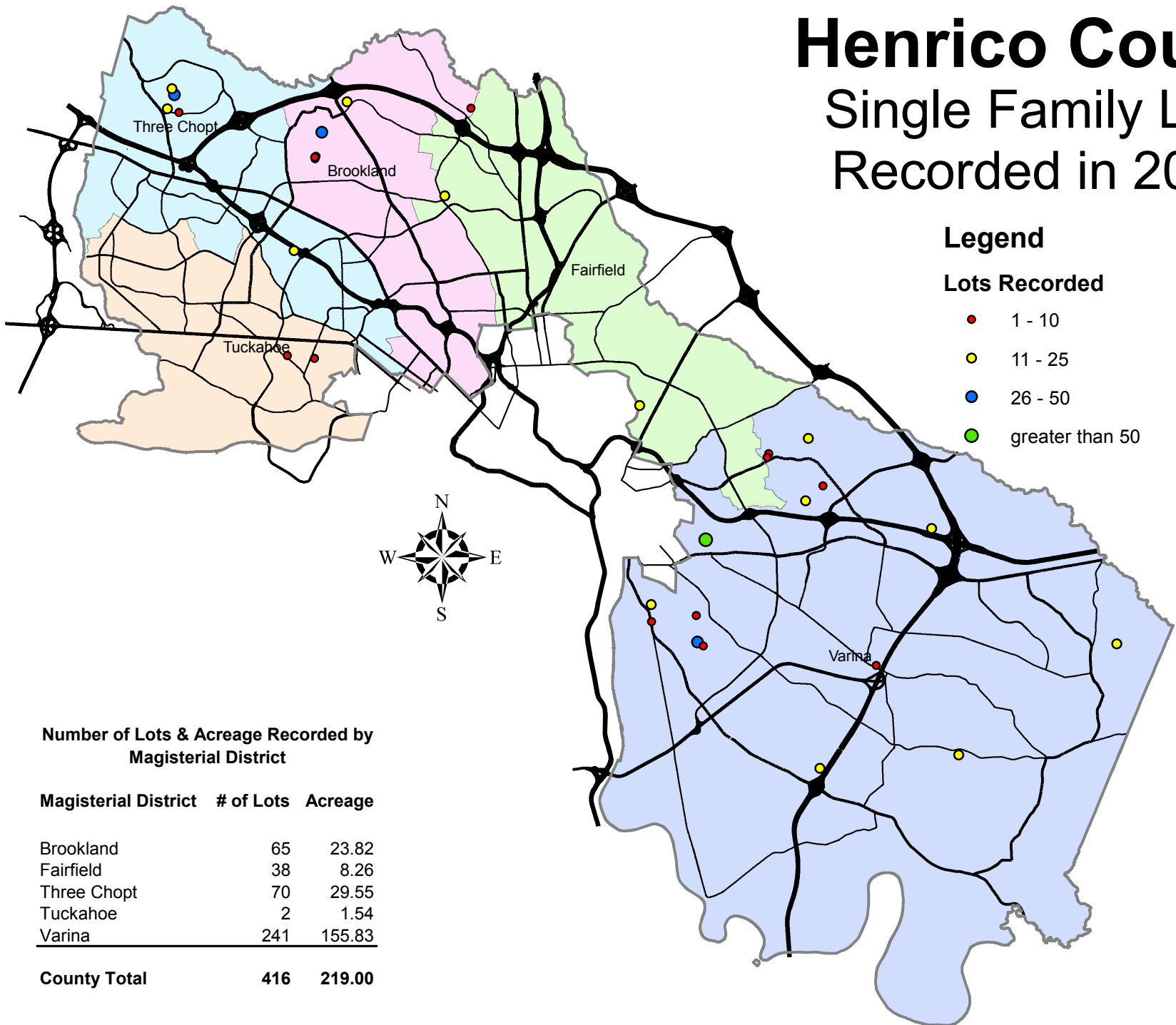

- Legend**
- Lots Recorded**
- 1 - 10
 - 11 - 25
 - 26 - 50
 - greater than 50

Number of Lots & Acreage Recorded by Magisterial District

Magisterial District	# of Lots	Acreage
Brookland	65	23.82
Fairfield	38	8.26
Three Chopt	70	29.55
Tuckahoe	2	1.54
Varina	241	155.83
County Total	416	219.00

Source: Henrico County Single Family Recorded Subdivisions Directory January 2009



2008 Recorded Subdivisions

<i>Subdivision</i>	<i>Section</i>	<i>Lot(s)</i>	<i>Acreage in Lots</i>	<i>AVG Lot</i>	<i>Zoning</i>	<i>Case #</i>	<i>Parcel Number</i>	<i>Recorded</i>
Brookland								
Old Springfield Farm Old Springfield Rd		15	6.2350	0.4157	R-2AC	C-48C-05	762-771-2135	11/13/2008
Ponds at Dandridge Farm Olde Mill Pond Pl & Olde Mill Pond Dr	D	2	0.6260	0.313	R-3AC	C-35C-99	758-764-1539	9 /8 /2008
Ponds at Dandridge Farm Olde Mill Pond Pl & Olde Mill Pond Dr	E	3	0.8510	0.2837	R-3AC	C-35C-99	758-764-2846	3 /20/2008
Ponds at Dandridge Farm Olde Mill Pond Pl & Olde Mill Pond Dr	F	3	0.9520	0.3173	R-3AC	C-35C-99	758-764-1818	10/6 /2008
Townsend Francistown Rd	1	39	10.4000	0.2667	R-5AC	C-61C-04, C-82C-05	759-767-0453	9 /23/2008
Winfrey Meadows Winfrey Rd	1	3	4.7600	1.5867	A-1		777-770-9154	9 /24/2008
Summary for Brookland (6 Subdivisions)								
Sum		65	23.8240	0.3665				

<i>Subdivision</i>	<i>Section</i>	<i>Lot(s)</i>	<i>Acreage in Lots</i>	<i>AVG Lot</i>	<i>Zoning</i>	<i>Case #</i>	<i>Parcel Number</i>	<i>Recorded</i>
Fairfield								
Collin Court Maelee Mews		13	4.0210	0.3093	R-3		774-759-5748	9 /12/2008
Dillyn Place Barrington Rd & Dillyn Place	1	25	4.2384	0.1695	R-5AC	C-65C-06	799-732-4991	6 /16/2008
Summary for Fairfield (2 Subdivisions)								
Sum		38	8.2594	0.2174				

<i>Subdivision</i>	<i>Section</i>	<i>Lot(s)</i>	<i>Acreage in Lots</i>	<i>AVG Lot</i>	<i>Zoning</i>	<i>Case #</i>	<i>Parcel Number</i>	<i>Recorded</i>
Three Chopt								
Estates at Grey Oaks Grey Oaks Park Rd & Grey Oaks Park Dr	1	16	5.9500	0.3719	R-2AC	C-15C-03	740-773-0703	1 /22/2008
Estates at Grey Oaks Grey Oaks Park Rd & Grey Oaks Park Dr	2	28	12.1000	0.4321	R-2AC	C-15C-03	740-772-3824	6 /2 /2008
Mason Park Shady Grove Rd	2	11	6.1090	0.5554	R-2AC	C-18C-07	739-770-5246	7 /8 /2008
Mason Park Shady Grove Rd	3	2	1.0030	0.5015	R-2AC	C-18C-07	740-770-9305	9 /25/2008
Parham Estates Starwood Dr	2	13	4.3860	0.3374	R-3		755-752-5455	12/30/2008

Summary for Three Chopt (5 Subdivisions)

Sum		70	29.5480	0.4221				
------------	--	-----------	----------------	---------------	--	--	--	--

<i>Subdivision</i>	<i>Section</i>	<i>Lot(s)</i>	<i>Acreage in Lots</i>	<i>AVG Lot</i>	<i>Zoning</i>	<i>Case #</i>	<i>Parcel Number</i>	<i>Recorded</i>
Tuckahoe								
Paris Ridge Paris Dr & Paris Ridge Ln	2	1	1.2070	1.2070	R-3		758-738-0885	2 /19/2008
Ridgeview Ridge Rd	4	1	0.3320	0.332	R-3		754-739-6321	4 /18/2008
Summary for Tuckahoe (2 Subdivisions)								
Sum		2	1.5390	0.7695				

<i>Subdivision</i>	<i>Section</i>	<i>Lot(s)</i>	<i>Acreage in Lots</i>	<i>AVG Lot</i>	<i>Zoning</i>	<i>Case #</i>	<i>Parcel Number</i>	<i>Recorded</i>
Varina								
Beechwood Park Oakridge Ave	C	18	9.9220	0.5512	R-3		820-728-6074	5 /21/2008
Boundary at Edge Hill New Osborne Tpke		14	4.6900	0.3350	R-3		800-707-7170	9 /15/2008
Britton Oaks Old Charles City Rd	2	5	7.6550	1.5310	A-1		829-700-2008	1 /10/2008
Buena Vista Eden Ave & Ada St	2	5	1.5130	0.3026	R-3		806-706-4136	4 /22/2008
Four Mile Run Heather Ridge Dr & Migration Dr	H	11	7.3040	0.664	R-2AC	C-67C-97, C-32C-05	822-687-0501	6 /17/2008
Highland Springs S Kalmia Ave	19	2	1.2940	0.6470	R-3 & R-4		822-722-4278	10/2 /2008
Hill Valley Nine Mile Rd	1	4	1.1170	0.2792	R-3		815-726-3935	7 /23/2008
Hill Valley Nine Mile Rd	2	9	8.4150	0.935	R-3		815-726-5573	12/30/2008
Midview Farms Midview Rd & New Market Rd	B	38	13.4670	0.3544	R-2AC	C-17C-05, C-81C-05	806-702-5598	1 /4 /2008
Midview Manor Midview Rd	A	5	3.5310	0.7062	R-2AC	C-27C-07	807-702-2951	4 /4 /2008
Morrow Heights Summer St		23	11.2910	0.4909	R-3		820-720-1986	11/3 /2008
New Market Landing Osborne Tpke	B	1	0.3560	0.3560	R-3		800-705-7654	12/12/2008
Prosperity Estates Darbytown Rd	A	21	25.9910	1.2377	A-1		839-688-6268	12/5 /2008

<i>Subdivision</i>	<i>Section</i>	<i>Lot(s)</i>	<i>Acreage in Lots</i>	<i>AVG Lot</i>	<i>Zoning</i>	<i>Case #</i>	<i>Parcel Number</i>	<i>Recorded</i>
Scandia Farms Scandia Rd		13	17.8100	1.37	A-1		859-702-6375	7 /25/2008
Silver Meadows Silver Ridge Ct & Silver Meadows Dr	A	21	27.3600	1.3029	A-1		836-717-2032	3 /24/2008
Virginia Farms Eanes Ln & Bromby St		51	14.1170	0.2768	R-4		807-715-6193	5 /16/2008

Summary for Varina (16 Subdivisions)

Sum	241	155.8330	0.6466
Grand Total	416	219.0034	0.5265

Magisterial District by Year Report

<i>Year</i>	<i>Magisterial District</i>	<i>Lots</i>	<i>Lot Acreage</i>	<i>Average Lot</i>	<i>ROW Acreage</i>	<i>Open Space Acreage</i>
<i>2004</i>						
	Brookland (11 subdivisions)	348	88.4960	0.2543	12.0020	14.4000
	Fairfield (6 subdivisions)	210	67.8870	0.3233	11.6890	1.9730
	Three Chopt (18 subdivisions)	392	112.1420	0.2861	22.1040	33.1980
	Tuckahoe (4 subdivisions)	34	14.1380	0.4158	3.0130	1.0000
	Varina (11 subdivisions)	423	188.5750	0.4458	29.8100	9.8520
Summary for 2004 = 50 subdivisions		1,407	471.2380	0.3349	78.6180	60.4230
<i>2005</i>						
	Brookland (16 subdivisions)	274	107.6703	0.393	14.0456	21.0540
	Fairfield (9 subdivisions)	132	49.7075	0.3766	7.6560	1.9890
	Three Chopt (13 subdivisions)	291	111.2210	0.3822	19.9260	20.4970
	Tuckahoe (3 subdivisions)	65	35.6660	0.5487	5.8920	6.7090
	Varina (22 subdivisions)	442	368.8005	0.8344	34.9870	17.7224
Summary for 2005 = 63 subdivisions		1,204	673.0653	0.5590	82.5066	67.9714

<i>Year</i>	<i>Magisterial District</i>	<i>Lots</i>	<i>Lot Acreage</i>	<i>Average Lot</i>	<i>ROW Acreage</i>	<i>Open Space Acreage</i>
<i>2006</i>						
	Brookland (12 subdivisions)	278	148.4167	0.5339	18.9114	21.2960
	Fairfield (14 subdivisions)	267	94.9890	0.3558	15.5390	7.9090
	Three Chopt (9 subdivisions)	218	92.8000	0.4257	13.2680	28.5450
	Tuckahoe (3 subdivisions)	61	31.6100	0.5182	5.1740	2.0900
	Varina (16 subdivisions)	390	348.1960	0.8928	30.3600	33.7520
Summary for 2006 = 54 subdivisions		1,214	716.0117	0.5898	83.2524	93.5920
<i>2007</i>						
	Brookland (6 subdivisions)	35	16.9210	0.4835	1.1740	0.0000
	Fairfield (8 subdivisions)	362	128.0640	0.3538	25.5910	30.6940
	Three Chopt (6 subdivisions)	140	83.7360	0.5981	16.4110	18.2200
	Tuckahoe (4 subdivisions)	35	18.0680	0.5162	2.8920	2.2300
	Varina (20 subdivisions)	295	321.5230	1.0899	28.8850	298.2120
Summary for 2007 = 44 subdivisions		867	568.3120	0.6555	74.9530	349.3560

<i>Year</i>	<i>Magisterial District</i>	<i>Lots</i>	<i>Lot Acreage</i>	<i>Average Lot</i>	<i>ROW Acreage</i>	<i>Open Space Acreage</i>
<i>2008</i>						
	Brookland (6 subdivisions)	65	23.8240	0.3665	5.3960	12.7680
	Fairfield (2 subdivisions)	38	8.2594	0.2174	1.9276	1.5535
	Three Chopt (5 subdivisions)	70	29.5480	0.4221	4.6740	3.1870
	Tuckahoe (2 subdivisions)	2	1.5390	0.7695	0.0000	0.0000
	Varina (16 subdivisions)	241	155.8330	0.6466	20.4960	2.4490
Summary for 2008 = 31 subdivisions		416	219.0034	0.5265	32.4936	19.9575
<i>Grand Total (2004 - 2008)</i>		5,108	2,647.6304	0.5183	351.8236	591.2999