

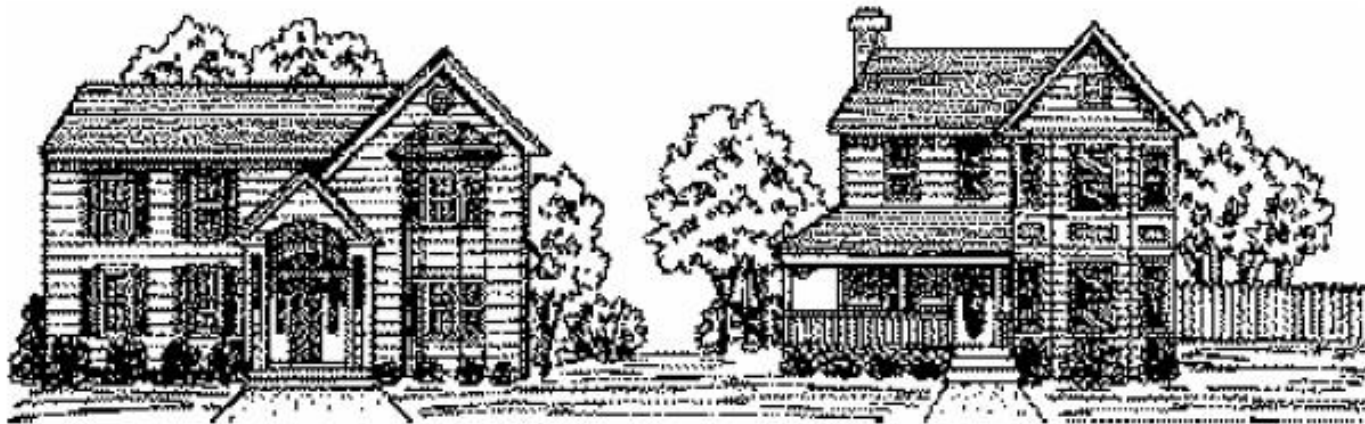

Henrico County
2009

Recorded Single Family Subdivisions



County of Henrico Planning Department
.....Octej 2010

METHODOLOGY FOR THE 2009 RECORDED SINGLE-FAMILY SUBDIVISION REPORT

The *Recorded Single-Family Subdivision Report*, compiled annually by the Henrico County Planning Department, records single family subdivisions by Magisterial District. The units and acreage recorded in the report account for all units and acreage approved for each section of the subdivisions as recorded with the record of deeds in the Circuit Court Clerk's Office.

The data used to create the reports is derived from Henrico County's Planning Department records of recorded subdivisions. This information is documented by the Henrico County Planning Department after the final plat is recorded in the Circuit Court Clerk's Office.

For more information contact the Planning Department at (804) 501-4602.

Henrico County

Single Family Lots Recorded in 2009

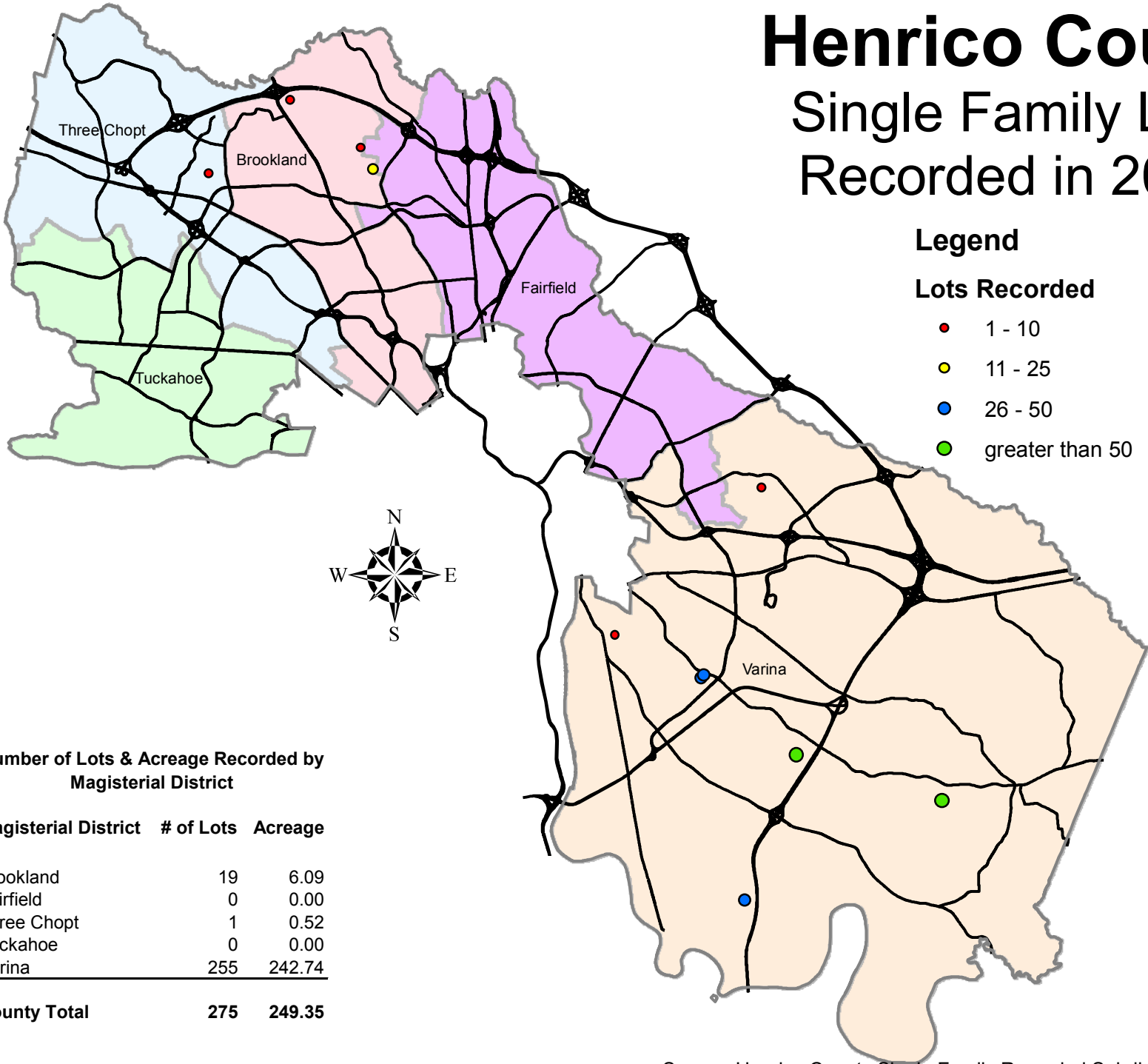

Number of Lots & Acreage Recorded by Magisterial District

Magisterial District	# of Lots	Acreage
Brookland	19	6.09
Fairfield	0	0.00
Three Chopt	1	0.52
Tuckahoe	0	0.00
Varina	255	242.74
County Total	275	249.35

Source: Henrico County Single Family Recorded Subdivisions Directory
January 2010

2009 Recorded Subdivisions

<i>Subdivision</i>	<i>Section</i>	<i>Lot(s)</i>	<i>Acreage in Lots</i>	<i>AVG Lot</i>	<i>Zoning</i>	<i>Case #</i>	<i>Parcel Number</i>	<i>Recorded</i>
Brookland								
Glen Cove Glen Cove Rd & Purcell Rd		6	2.1950	0.3658	R-3		770-765-9795	3 /16/2009
Springfield Old Springfield Rd & Old Mountain Rd	C	2	0.8260	0.413	R-4		762-771-3985	8 /3 /2009
Winston Trace Winston Trace Cir & Winston Blvd		11	3.0700	0.2791	R-3		772-763-4637	4 /1 /2009
Summary for Brookland (3 Subdivisions)								
Sum		19	6.0910	0.3206				

<i>Subdivision</i>	<i>Section</i>	<i>Lot(s)</i>	<i>Acreage in Lots</i>	<i>AVG Lot</i>	<i>Zoning</i>	<i>Case #</i>	<i>Parcel Number</i>	<i>Recorded</i>
--------------------	----------------	---------------	------------------------	----------------	---------------	---------------	----------------------	-----------------

Three Chopt

Lexington Lexington Farm Dr	5	1	0.5190	0.519	R-3A		752-762-4289	8 /31/2009
--------------------------------	---	---	--------	-------	------	--	--------------	------------

Summary for Three Chopt (1 detail record)

Sum		1	0.5190	0.5190				
------------	--	----------	---------------	---------------	--	--	--	--

<i>Subdivision</i>	<i>Section</i>	<i>Lot(s)</i>	<i>Acreage in Lots</i>	<i>AVG Lot</i>	<i>Zoning</i>	<i>Case #</i>	<i>Parcel Number</i>	<i>Recorded</i>
Varina								
Castleton Macallan Pkwy	2	61	15.5000	0.2541	R-3AC	C-39C-89, C-39C-90, C-41C-90	824-689-0591	1 /29/2009
Kingsland Pointe Varina Rd & Kingsland Pointe Dr		48	81.7300	1.7027	A-1		817-674-7632	10/6 /2009
Mansfield Woods Carters Mill Rd and Darbytown Rd	1	64	133.2994	2.0828	A-1		841-686-7444	2 /13/2009
New Market Village Darbytown Rd & New Market Village Blvd	1	28	4.8221	0.1722	R-5AC	C-79C-05	812-701-7581	4 /30/2009
New Market Village Darbytown Rd & New Market Village Blvd	2	47	4.2007	0.0894	RTHC	C-79C-05	812-701-2146	5 /13/2009
Osborne Oakland Rd		4	2.1622	0.5405	R-3		801-706-9866	12/22/2009
South Lake Hawkes Ln & South Lake Ave	A	3	1.0320	0.344	R-2A		819-724-8056	4 /22/2009

Summary for Varina (7 Subdivisions)

Sum	255	242.7464	0.9519
Grand Total	275	249.3564	0.9068

Magisterial District by Year Report

<i>Year</i>	<i>Magisterial District</i>	<i>Lots</i>	<i>Lot Acreage</i>	<i>Average Lot</i>	<i>ROW Acreage</i>	<i>Open Space Acreage</i>
<i>2005</i>						
	Brookland (16 subdivisions)	274	107.6703	0.393	14.0456	21.0540
	Fairfield (9 subdivisions)	132	49.7075	0.3766	7.6560	1.9890
	Three Chopt (13 subdivisions)	291	111.2210	0.3822	19.9260	20.4970
	Tuckahoe (3 subdivisions)	65	35.6660	0.5487	5.8920	6.7090
	Varina (22 subdivisions)	442	368.8005	0.8344	34.9870	17.7224
Summary for 2005 = 63 subdivisions		1,204	673.0653	0.5590	82.5066	67.9714
<i>2006</i>						
	Brookland (12 subdivisions)	278	148.4167	0.5339	18.9114	21.2960
	Fairfield (14 subdivisions)	267	94.9890	0.3558	15.5390	7.9090
	Three Chopt (9 subdivisions)	218	92.8000	0.4257	13.2680	28.5450
	Tuckahoe (3 subdivisions)	61	31.6100	0.5182	5.1740	2.0900
	Varina (16 subdivisions)	390	348.1960	0.8928	30.3600	33.7520
Summary for 2006 = 54 subdivisions		1,214	716.0117	0.5898	83.2524	93.5920

<i>Year</i>	<i>Magisterial District</i>	<i>Lots</i>	<i>Lot Acreage</i>	<i>Average Lot</i>	<i>ROW Acreage</i>	<i>Open Space Acreage</i>
<i>2007</i>						
	Brookland (6 subdivisions)	35	16.9210	0.4835	1.1740	0.0000
	Fairfield (8 subdivisions)	362	128.0640	0.3538	25.5910	30.6940
	Three Chopt (6 subdivisions)	140	83.7360	0.5981	16.4110	18.2200
	Tuckahoe (4 subdivisions)	35	18.0680	0.5162	2.8920	2.2300
	Varina (20 subdivisions)	295	321.5230	1.0899	28.8850	298.2120
Summary for 2007 = 44 subdivisions		867	568.3120	0.6555	74.9530	349.3560
<i>2008</i>						
	Brookland (6 subdivisions)	65	23.8240	0.3665	5.3960	12.7680
	Fairfield (2 subdivisions)	38	8.2594	0.2174	1.9276	1.5535
	Three Chopt (5 subdivisions)	70	29.5480	0.4221	4.6740	3.1870
	Tuckahoe (2 subdivisions)	2	1.5390	0.7695	0.0000	0.0000
	Varina (16 subdivisions)	241	155.8330	0.6466	20.4960	2.4490
Summary for 2008 = 31 subdivisions		416	219.0034	0.5265	32.4936	19.9575
<i>2009</i>						
	Brookland (3 subdivisions)	19	6.0910	0.3206	0.9610	0.1000
	Three Chopt (1 subdivisions)	1	0.5190	0.519	0.0000	1.8980
	Varina (7 subdivisions)	255	242.7464	0.9519	25.9352	14.0676
Summary for 2009 = 11 subdivisions		275	249.3564	0.9068	26.8962	16.0656
<i>Grand Total (2005 - 2009)</i>		3,976	2,425.7488	0.6101	300.1018	546.9425